

Date	Rev. date	Work nr.	Drw. nr.	Rev.
Drawn by Ruukki	Rev.	M35/S02	-	
Scale 1:2	Building	File nr. P2021/001-00036		

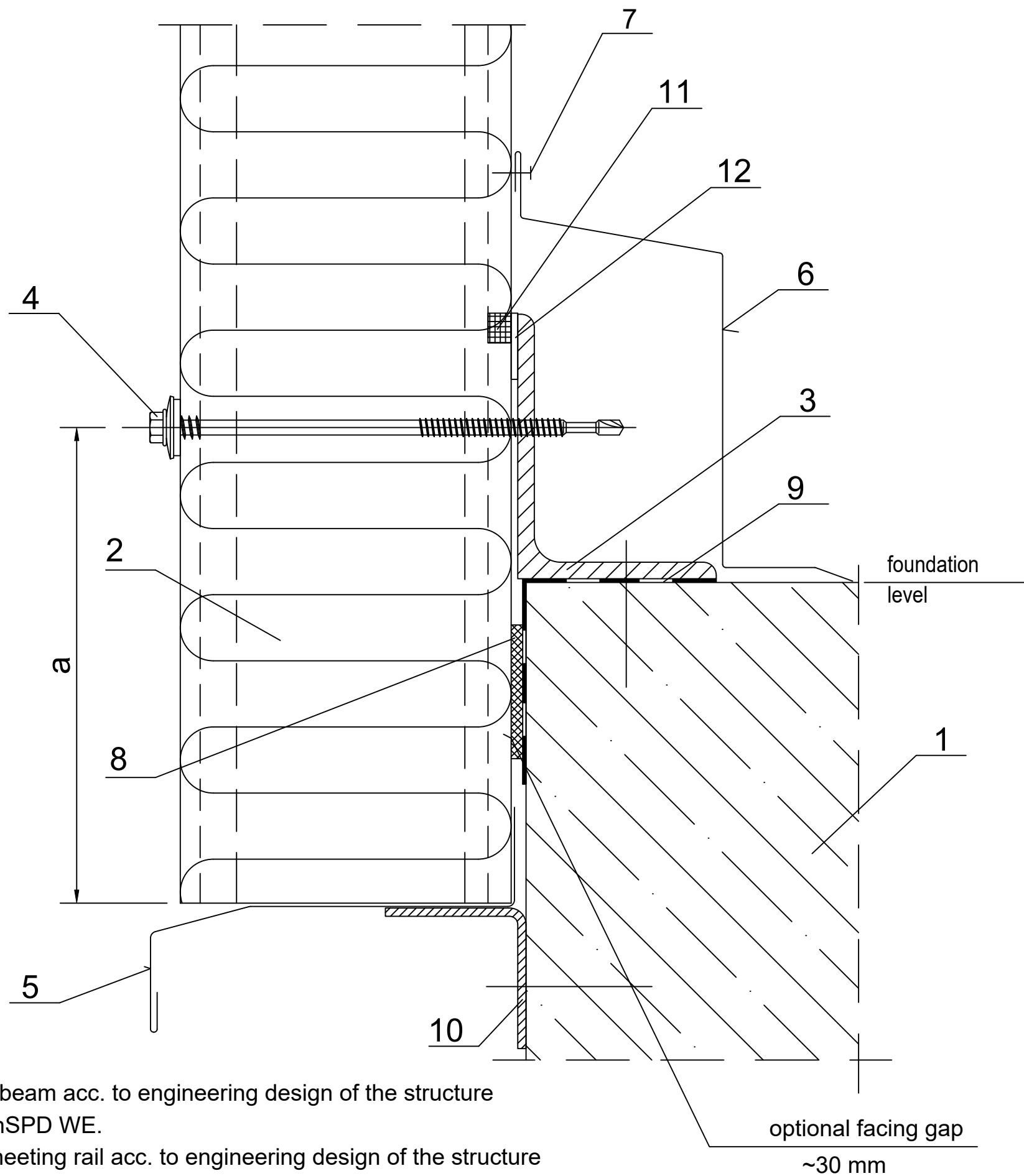

- 1. Ground beam acc. to engineering design of the structure
- 2. Ruukki nSPD WE.
- 3. Socle sheeting rail acc. to engineering design of the structure
- 4. Panel fastener for hot-rolled sheeting rail or for cold-bent sheeting rail.
- 5. EA1B01 plinth flashing.
- 6. EA1B02 plinth flashing.
- 7. Steel rivet (every 300 mm).
- 8. 8x40 PU self-adhesive sealant.
- 9. Horizontal insulation acc. to architectual design of the structure
- 10. Socle beam acc. to engineering design of the structure .
- 11. Permanently elastic sealing compound in panel joint .
- 12. 4x20 PU self-adhesive sealant.

panel thickness [mm]	min. distance from the panel edge "a" [mm]
< 150	30
≥ 150	40